

Jim Pattison Children's Hospital From College Drive:



Follow the signs to Jim Pattison Children's Hospital/
Main Entrance Parking staying to the left

Jim Pattison Children's Hospital



1 hour spots for labour and delivery

5th floor of Parkade

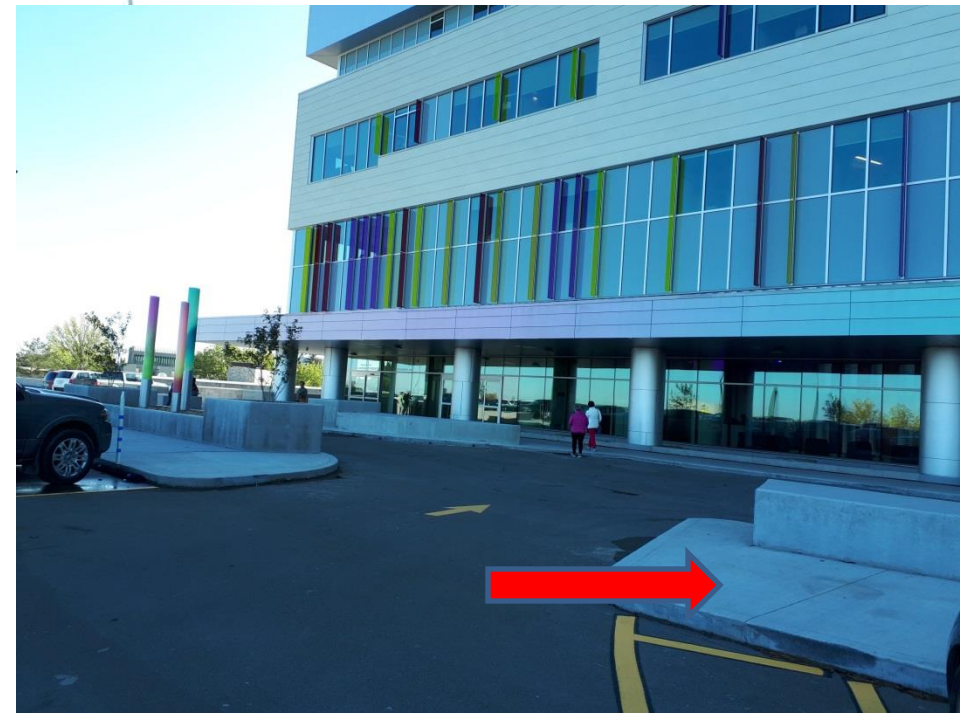

Main Lobby



Turn right past
main desk and
go to the red
elevators



Main Elevators

Go to the 3rd floor for Maternal Care



Saskatchewan
Health Authority

Walk-in Registration

If you are arriving in labour



Appointment Registration

If you have an appointment with Maternal Care



Family Waiting Area

Nice large space for family just behind registration



Saskatchewan
Health Authority

Layout of the 3rd Floor – Maternal Care

Triage – registration desk

Assessment – 8 maternal fetal assessment rooms

Prenatal (previously antenatal) - 8 rooms for non-labouring Moms needing monitoring

Maternal Care Unit - 49 rooms or LDRPs (labour, delivery, recovery, postpartum)

Operating rooms - 3

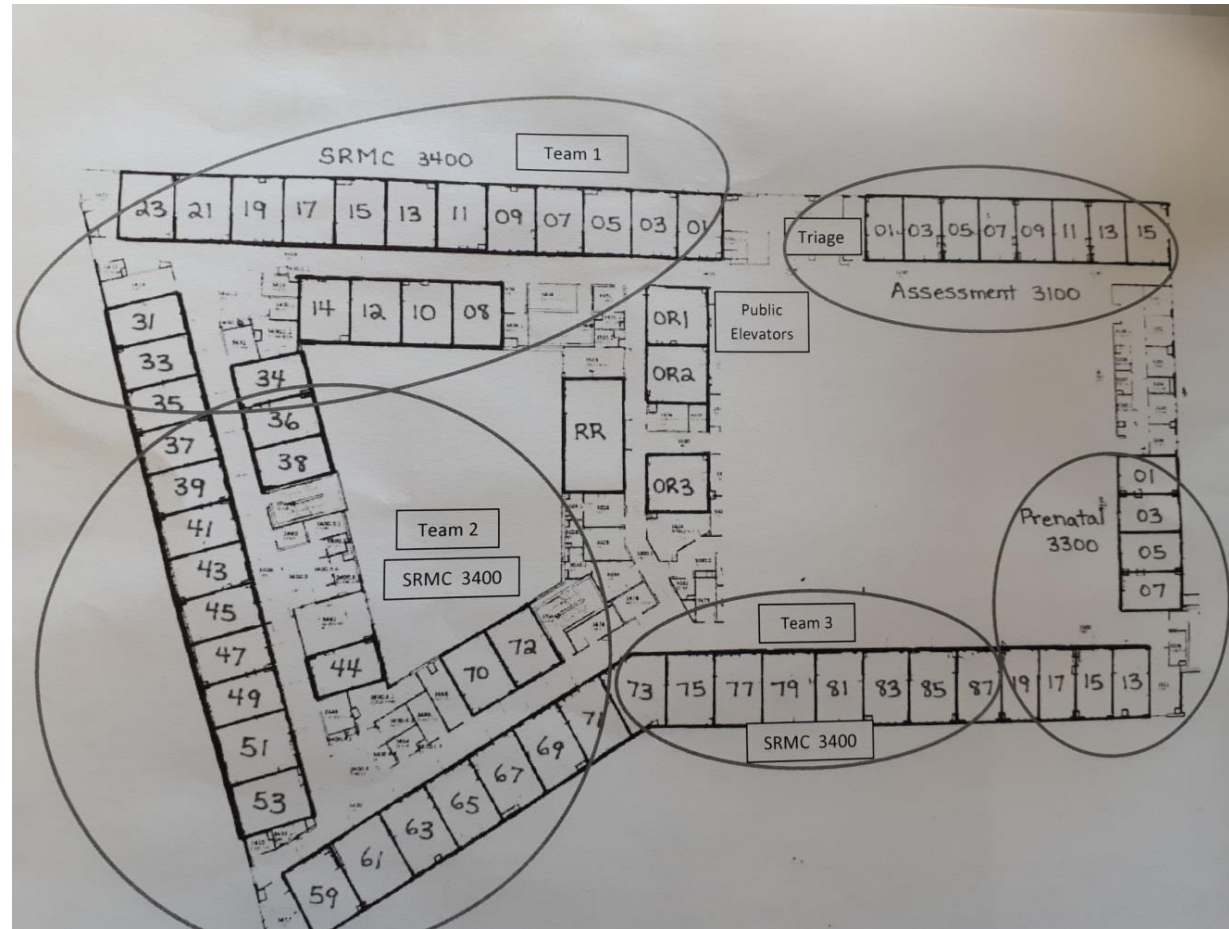

Maternal
Assessment Room



3101

Pull-out couches for labour support person to sleep on



Nursing/Admin. Station



 **HENNEPIN COUNTY**
You are on Level 3 ③

→
 Maternal Care
Rooms 3443 - 3479

←
 Prenatal Unit

Family Room

 Maternal Care
Rooms 3481 - 3487



Single Care Maternity Rooms



Infant's Bassinette

Baby stays with you in your room at the bedside. Bedding, diapers, receiving blankets and infant gowns, washcloths and Vaseline are all provided



Tubs and Showers

Most rooms have private tubs. Those few without a tub have a hand-held shower.



Surgical Suite for Ceasarean Delivery

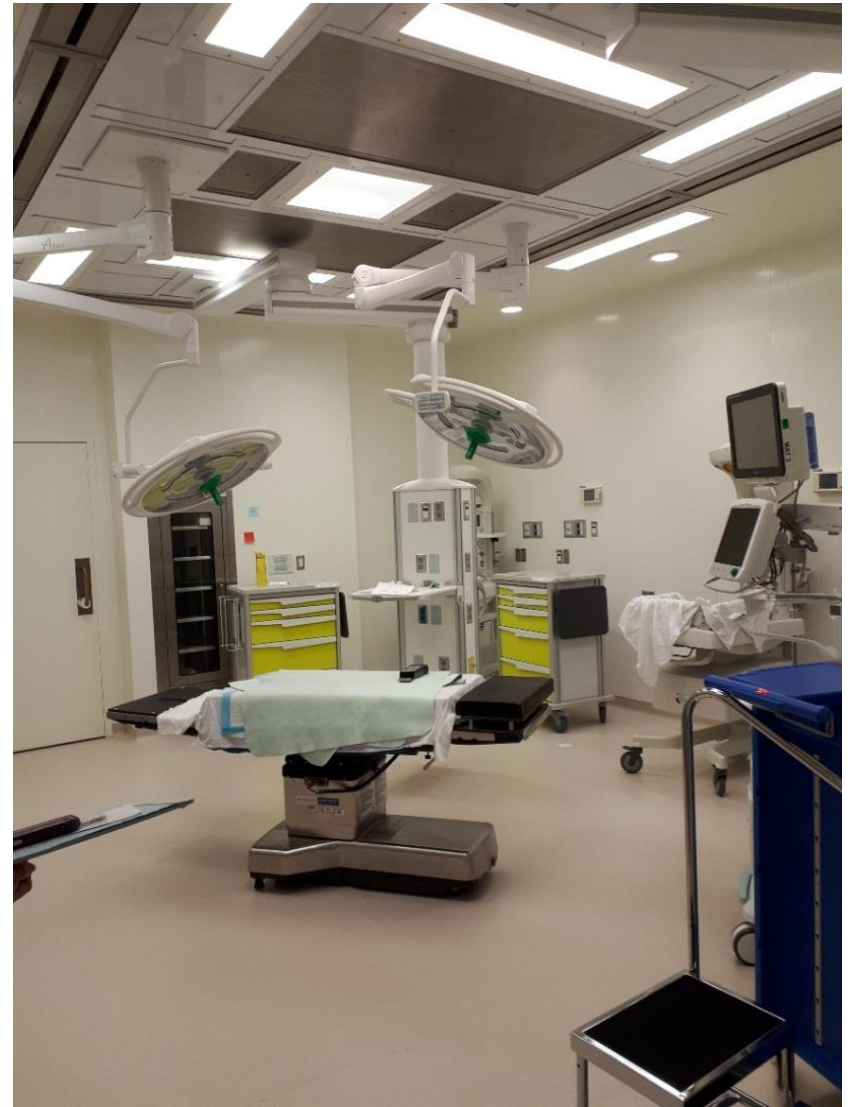

Panda Warmer

Skin-to-skin is always best, but this warmer can be used when baby needs extra attention or can't go skin-to-skin.

